

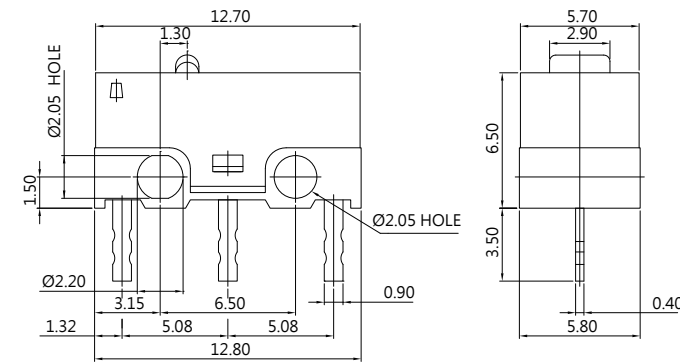

## DIMENSIONS

Unless otherwise specified, a tolerance of ±0.4mm applies to all dimensions.



## CONTACT CONFIGURATION

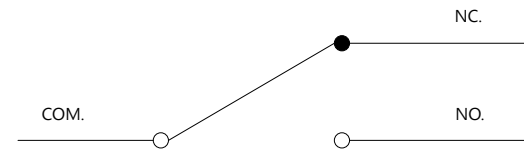

## MOUNTING HOLES

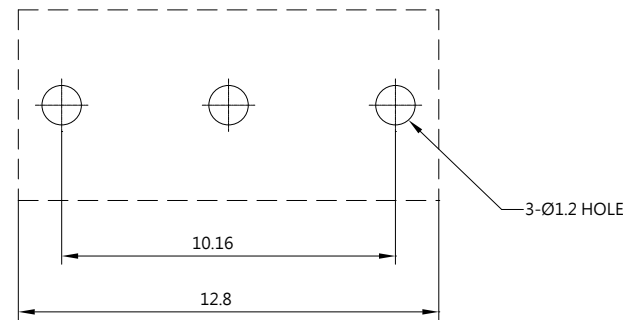

## CERTIFICATE INFORMATION

Model Name	UL, cUL	ENEC14
DM-03	0.1 / 1A / 3A 125VAC (Temp65°C) 0.1A / 0.2A 48VDC / 60VDC Min. 6,000 operations	1A / 3A 125VAC, µ 1E4

## THE SELECTION OF RATING & FORCE

Model	Rating	L	S
DM	0.1A	*	*
	0.2A	*	*
	3A	*	*

NOTE : The Symbol " \* " to represent the result is accepted

## TERMINAL TYPES

C TYPE

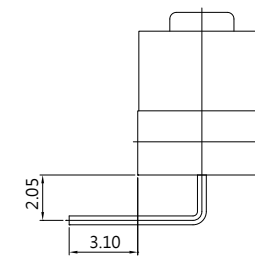

D TYPE

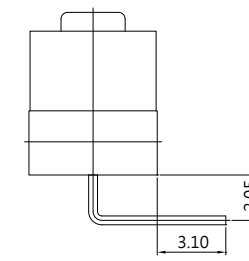

E TYPE

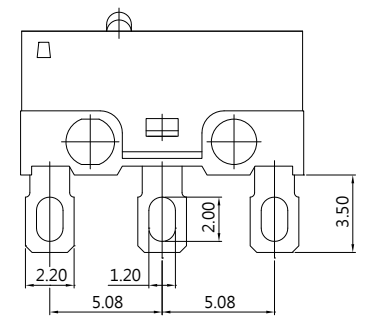

F TYPE

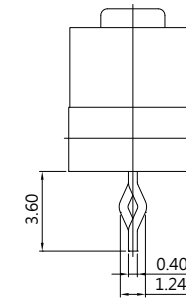

P TYPE

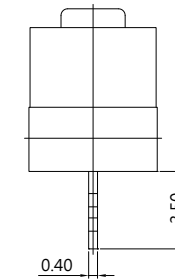

## ORDERING INFORMATION

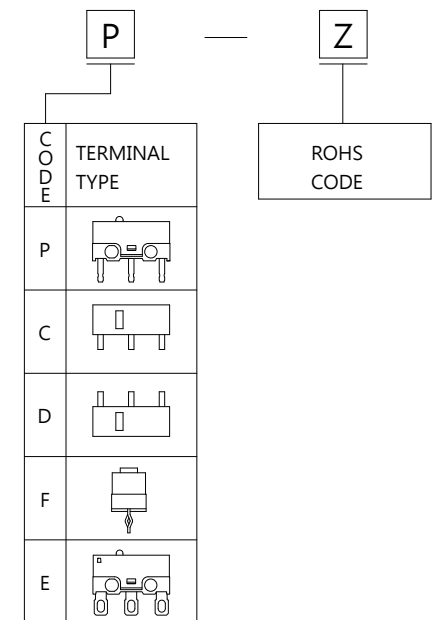
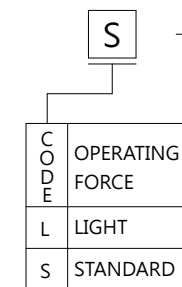
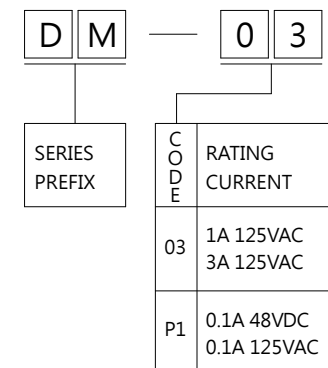

DM-03 □ - □□ -A  
is for gold plated contacts rating  
0.1A 48VDC ; 0.1A 125VAC ; 0.2A 60VDC ;  
1A 125VAC ; 3A 125VAC.

## DM SERIES

### SPECIFICATIONS

#### Contact Resistance(initial)

Max. 100 mΩ  
Measured by ohm meter - open voltage < 1VDC, driver current -100 mA

#### Insulation Resistance (at 500 VDC / minute)

Min. 100 MΩ

#### Dielectric Strength

1000 VAC(50~ 60 Hz)

#### Storage Temperature Range

-25°C to 85°C (with no icing)

#### Storage Humidity

At 40°C, Max. 85% R.H

#### Operating Temperature Range

-40°C to 65°C (with no icing)

#### Vibration

10~55 Hz, displacement 0.75 mm(p-p)

#### Electrical Service Life

0.1A, 0.2A - Min. 1,000,000 operations  
3A - Min. 10,000 operations

#### Electrical Operating Frequency

0.1A - 120 operations per minute  
3A - 10~30 operations per minute

#### Mechanical Service Life

Min. 1,000,000 operations

#### Mechanical Operating Frequency

120 operations per minute

### APPLICATIONS

Walkie talkie, Mouse, Electric knife, Electric stapler, Telephone, Calculator, Mixer & chopper, Electric pan, Battery charger, Video cassette reminder, Cordless phone, Tester machine

OPERATING CHARACTERISTICS

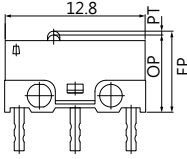
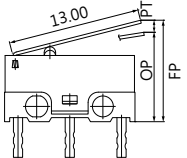
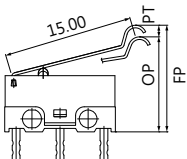
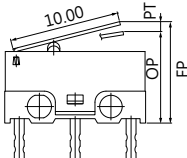
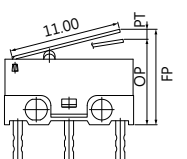
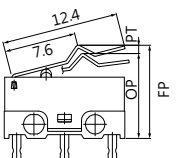
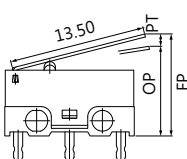
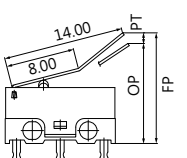
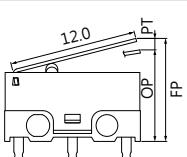
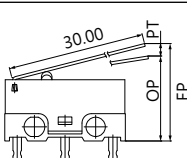
SWITCH TYPE	PART SUFFIX	OF Max. (gf)		OP (mm)	PT Max. (mm)	OT Min. (mm)	MD Max. (mm)	FP Max. (mm)	RF Min. (gf)
		L	S						
DM-03 □ -0 □ -Z		L	90	7.0±0.3	1.3	0.2	0.3	8.0	15
		S	150						20
DM-03 □ -1 □ -Z		L	30	8.4±0.8	3.4	0.6	1.3	11.0	5
		S	50						8
DM-03 □ -2 □ -Z		L	27	10.5±0.8	3.8	0.6	1.5	13.5	4
		S	45						7
DM-03 □ -3 □ -Z		L	40	7.9±0.8	3.4	0.6	1.0	10.5	6
		S	70						10
DM-03 □ -4 □ -Z		L	36	8.1±0.8	3.4	0.6	1.1	10.7	5
		S	65						9
DM-03 □ -5 □ -Z		L	53	8.9±0.8	2.9	0.6	0.8	11.0	8
		S	88						12
DM-03 □ -6 □ -Z		L	29	8.5±0.8	3.5	0.7	1.4	11.2	4
		S	50						7
DM-03 □ -7 □ -Z		L	29	11.3±1.0	3.7	0.3	1.4	14.0	4
		S	50						7
DM-03 □ -8 □ -Z		L	33	8.2±0.8	3.4	0.5	1.2	10.8	5
		S	60						8
DM-03 □ -9 □ -Z		L	15	10.79±2.1	10.1	0.9	3.0	16.9	2
		S	22	8.9±2.1					3