

# Joystick, drive lever with mechanical interlocking.

**Part No.**  
09-02.174C4.1113

**Mechanical characteristics**

- Mounting  
from below, 4 x M3 screws
- 1 axis
- No cross guidance
- No gate shape
- 20° deflection angle
- Handle "Central Lock"
- Resetting  
friction brake
- Actuating force from neutral tab  
-
- Max. actuating force in operation  
-
- Maximum force  
18000Nmm

**Electrical characteristics**

- Operating voltage  
max. 30VDC
- Technology  
conductive plastic
- Output signal  
proportional without centre tab
- No redundancy
- Connection  
Dubox plug (3-pole)
- No interface

**Ambient conditions**

- Operating temperature  
-30°C to +80°C
- Storage temperature  
-40°C to +85°C

**Degree of protection**

- IP65 front protection
- IP40 rear protection



Diagram Y-axis

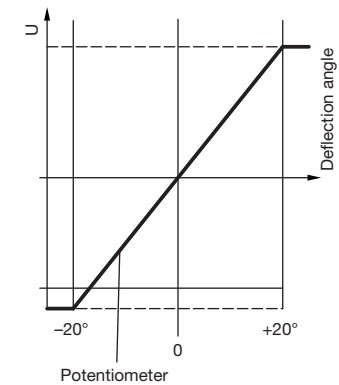

Dimensions

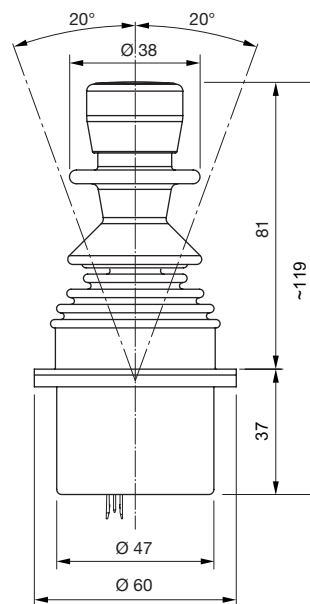

View from above

