

WATER PROOF SWITCHES

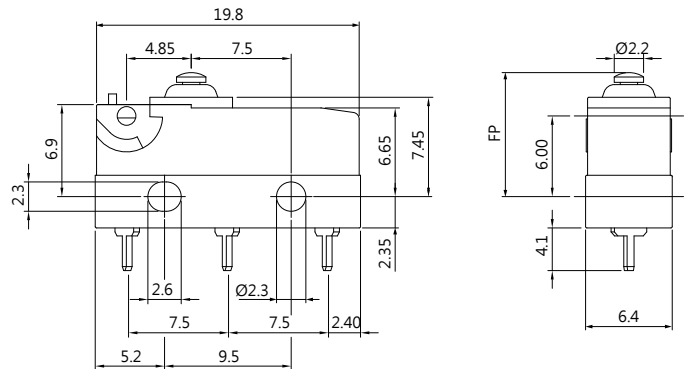

DIMENSIONS

Unless otherwise specified, a tolerance of $\pm 0.4\text{mm}$ applies to all dimensions.



SW SERIES

SPECIFICATIONS

Contact Resistance(initial)

Max. 30 m Ω

Measured by ohm meter - open voltage <1VDC, driver current -100 mA

Insulation Resistance (at 500 VDC / minute)

Min. 100 M Ω

Dielectric Strength

1000 VAC(50~ 60 Hz)

Storage Temperature Range

-25°C to 85°C (with no icing)

Storage Humidity

At 40°C , Max. 85% R.H.

Operating Temperature Range

-40°C to 120°C (with no icing)

Vibration

10~55 Hz, displacement 0.75 mm(p-p)

Electrical Service Life

Min. 10,000 operations

Electrical Operating Frequency

10~30 operations per minute

Mechanical Service Life

Min. 2,000,000 operations

Mechanical Operating Frequency

120 operations per minute

APPLICATIONS

Telephone, Air Conditioner, Computer, Humidifier, Alarm, Time Recorder, Mixer & Chopper, Solder Gun, Neon Phone, Fax Machine, Joystick, Water Pump, Gas Detector, Pencil Sharpener, Money Sorter, Food Processor, Electric Knife, Toy Car, Juice Maker, Electric Steak Pan

CONTACT CONFIGURATION

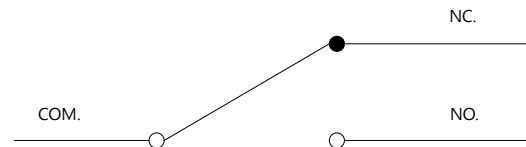

MOUNTING HOLES

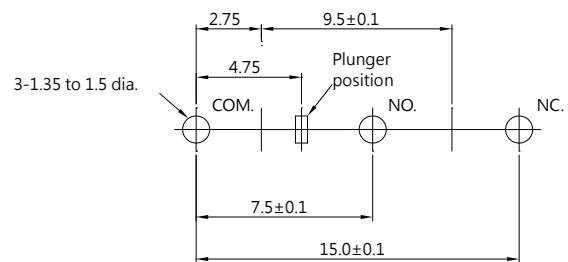
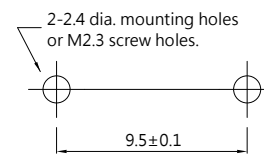

CERTIFICATE INFORMATION

Model Name	UL, cUL	ENEC14
SW-05S	0.1A/5A 30VDC 0.1A/5A 125/250VAC μ T120,1E4	6A 250VAC, μ T70 1E4 (PVC cable) 6A 250VAC, μ T120 1E4 (High heat resistant cable or bare terminal)

TERMINAL TYPES

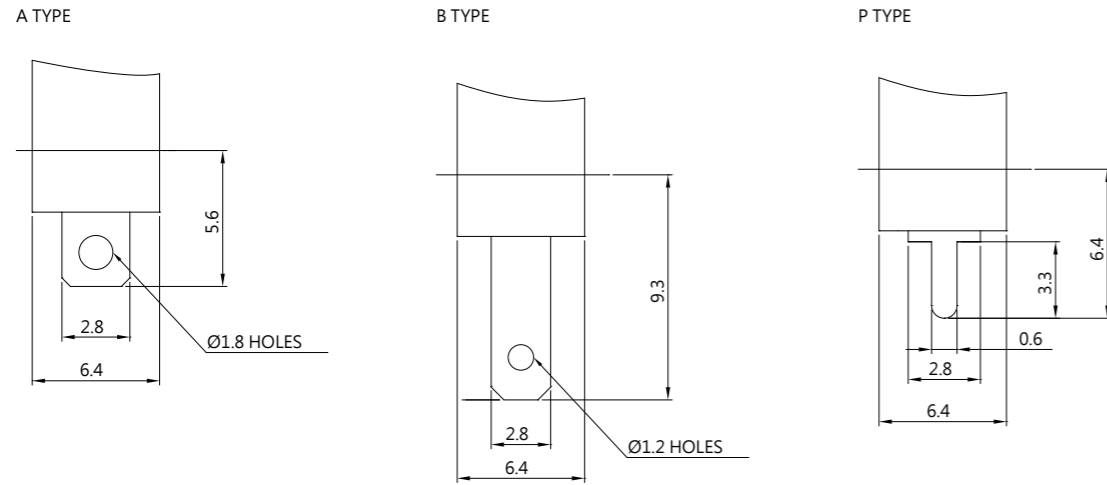

ORDERING INFORMATION

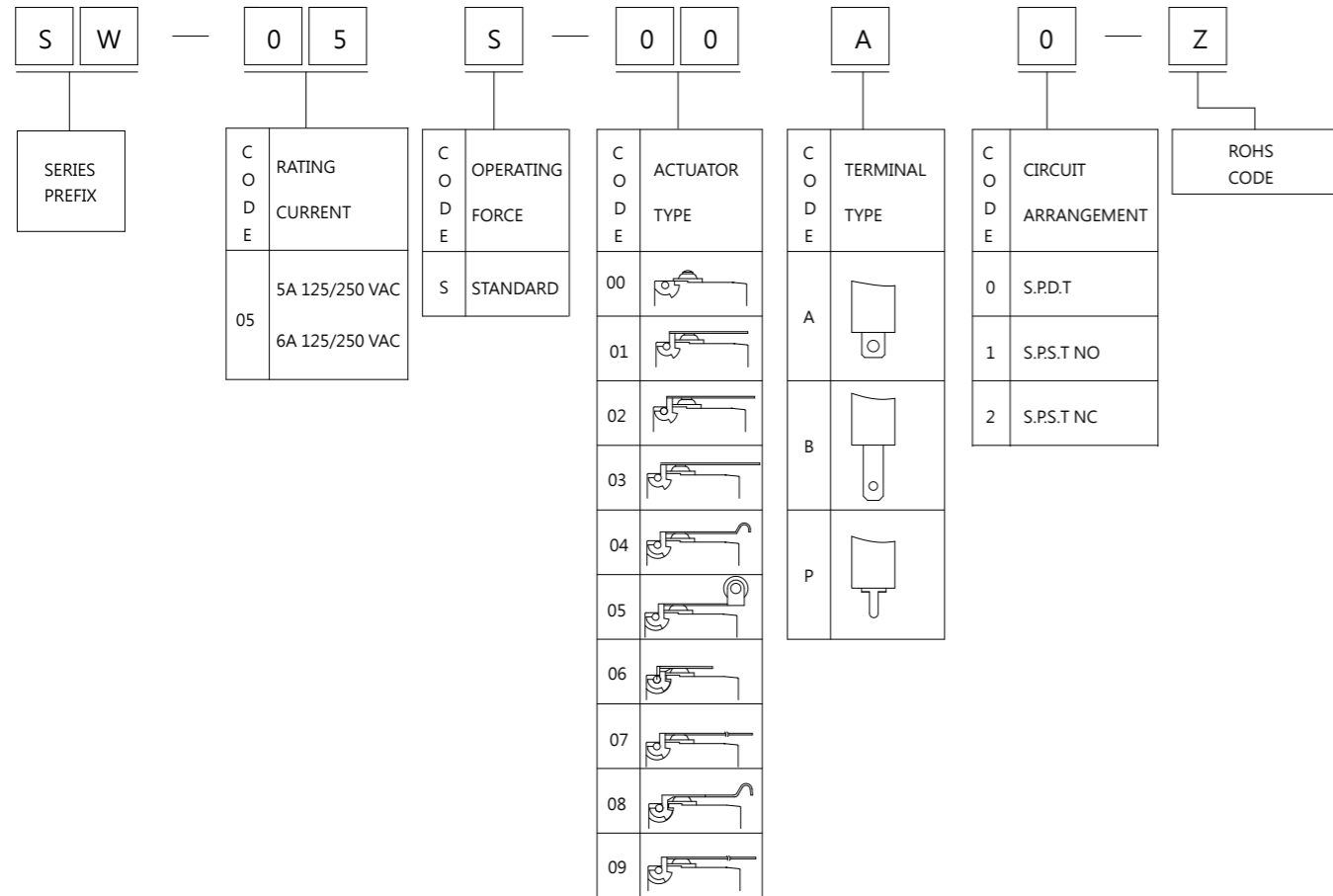

OPERATING CHARACTERISTICS

SWITCH TYPE	PART SUFFIX	OF Max. (gf)	OP (mm)	PT Max. (mm)	OT Min. (mm)	MD Max. (mm)	FP Max. (mm)	RF Min. (gf)
SW-05S-00 □□ -Z		203	8.4±0.3	1.2	0.6	0.2	9.9	50
SW-05S-01 □□ -Z		82	8.8±1.1	4.3	0.9	0.6	12.0	16
SW-05S-02 □□ -Z		66	8.8±1.2	4.8	1.0	0.7	12.4	13
SW-05S-03 □□ -Z		54	8.8±1.6	6.3	1.6	0.9	13.5	11
SW-05S-04 □□ -Z		68	10.7±1.2	4.6	1.0	0.65	14.1	14
SW-05S-05 □□ -Z		72	14.5±1.1	4.3	0.9	0.6	17.7	15
SW-05S-06 □□ -Z		98	8.8±0.9	3.2	0.6	0.5	11.1	21
SW-05S-07 □□ -Z		39	8.8±2.6	10.1	2.1	1.4	16.3	8
SW-05S-08 □□ -Z		68	11.3±1.3	4.9	0.95	0.8	14.9	13
SW-05S-09 □□ -Z		33	8.8±0.35	13.8	2.9	2	19.1	7