

PCB Mount Reed Switch

Product Name	Normally Open Reed Sensor	Item No.	SZFAST-G
---------------------	---------------------------	-----------------	----------

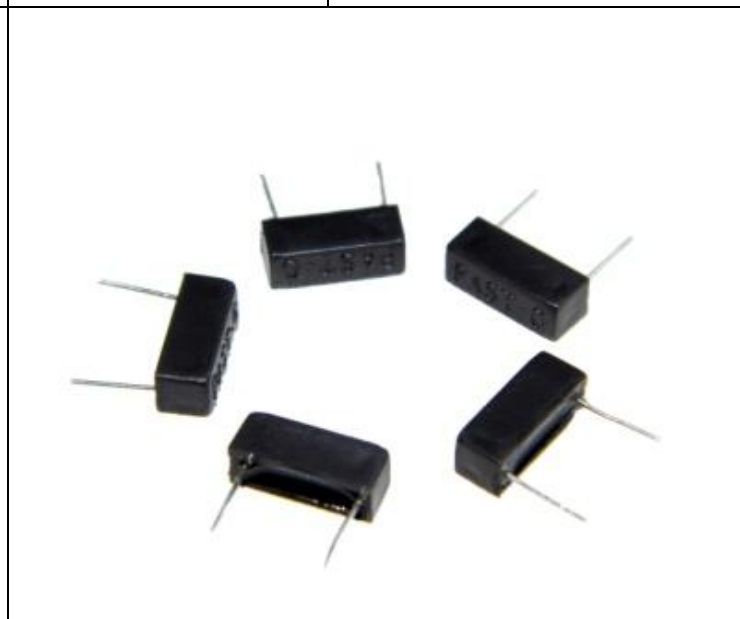
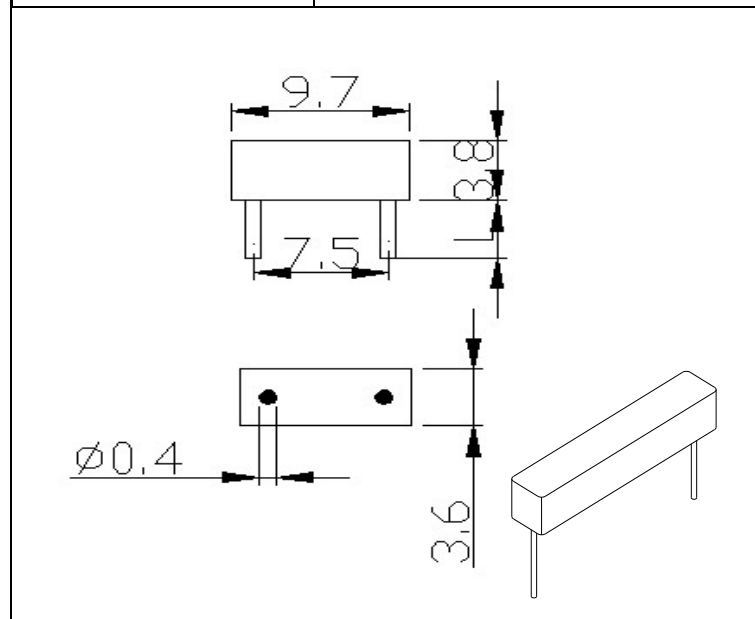

Switch Circuit	Switch Form	Built-in reed switch	Feature: 1. Operated in magnetic field. 2. Sensitive distance is optional 3. 2 pins Advantages: 1. Easy installation. 2. Passive switch, no need outer power 3. It can cut through any non-irony materials.
	Form A	RI-80 $\phi 1.8 \times 5 \text{mm}$	

Contact Form	1A SPST-N0	Breakdown voltage	230V
Contact Materials	Ru	Contact capacity	0.45pF
Contact Load	5W	Insulated resistance	$10^{12} \Omega$
Max. switching voltage	DC200V/AC140V	resonant frequency	21.3KHz
Max. switching current	0.35A	Work temperature	-55°C ~ +100°C
Max. contact resistance	140m Ω	Pull in value	AT9-15
Approve	Drawing	check	version release
ROHS\REACH\ICE	Yan Guo	Leo Li	2012-1-30

SHENZHEN FAST SENSOR CO.,LTD	TEL: 0755-3393 6919 FAX: 0755-3393 6682 Sophy Deng E-mail: sophy@faster.hk
http://www.szfast.com	

<p>SZFAST-A</p> <p>NO</p> <p>20 18 4 L $\phi 0.5$ 3.8</p>	<p>SZFAST-B</p> <p>NO</p> <p>16.5 13.8 4 L $\phi 0.45$ 3.8</p>	<p>SZFAST-C</p> <p>NO</p> <p>23.5 21 3.8 L $\phi 0.5$ 4.2</p>	<p>SZFAST-D</p> <p>NO</p> <p>24.5 20 4.6 L $\phi 0.5$ 4.5</p>
<p>SZFAST-E</p> <p>NO</p> <p>33 30 4 L $\phi 0.65$ 4.6</p>	<p>SZFAST-EB</p> <p>NB</p> <p>33 30 4 9 $\phi 0.5$ 4.6</p>	<p>SZFAST-EC</p> <p>CO</p> <p>33 30 4 L $\phi 0.65$ 4.6</p>	<p>SZFAST-F</p> <p>NO</p> <p>12.4 10 4 L $\phi 0.42$ 4</p>
<p>SZFAST-G</p> <p>NO</p> <p>9.7 7.5 3.8 L $\phi 0.4$ 3.6</p>	<p>SZFAST-H</p> <p>NO</p> <p>46 6.2 2.2 2.2</p>	<p>SZFAST-J</p> <p>NO</p> <p>46 11.7 2.2 3.0</p>	<p>SZFAST-J1</p> <p>NO</p> <p>中心跨距22 ± 0.2 11.6 2.9 12 2.9 3.0</p>
<p>SZFAST-M</p> <p>NO</p> <p>46 8.7 2.8 2.8</p>	<p>SZFAST-R1105</p> <p>NO</p> <p>$\phi 5$ 11 2 L</p>	<p>SZFAST-R1503</p> <p>NO</p> <p>$\phi 3.5$ 15 2 L</p>	<p>SZFAST-R1505</p> <p>NO</p> <p>$\phi 5$ 15 2 L</p>